

## GENERAL CHARACTERISTICS

For all applications where it is necessary to monitor or perform pressure measurements in industrial plants.

**Rugged construction for non-corrosive liquids**, sensing element bourdon tube. Process connections radial or axial.

- **ABS enclosure.**
- Plastic white dial.
- Bourdon tube measuring element made of copper alloy.
- Degree of protection IP43



## PRESSURE RANGES Tab.1

Measuring range Bar	Code	Ø mm.				
		40	50	63	80	100
-1 - 0	V001-0	↑	↑	↑	↑	↑
0 - 1	0001-0					
0 - 1,6	0001-6					
0 - 2,5	0002-5					
0 - 4	0004-0					
0 - 6	0006-0					
0 - 10	0010-0					
0 - 12	0012-0					
0 - 16	0016-0					
0 - 25	0025-0					
0 - 40	0040-0					
0 - 60	0060-0					
0 - 100	0100-0					
0 - 160	0160-0					
0 - 250	0250-0					
0 - 315	0315-0					
0 - 400	0400-0					

Dual scale on request: bar / psi

## TECHNICAL DATA Tab.2

Description			Code
Measuring element	Bourdon tube	Copper alloy	<b>BG</b>
Dial	Dry scale	Single scale	<b>N1</b>
		Dual scale	<b>N2</b>
Housing	Black ABS	IP43	-
Window	Polycarbonate		
Working temperature	-20 / +80 °C		<b>080</b>
Accuracy	Standard 2,5%		<b>25</b>
	On request 1,6%		<b>16</b>

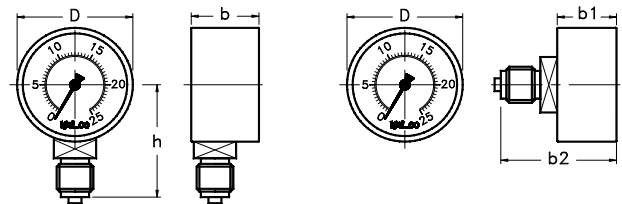

Ø	Dimensions [mm]					Weight [g]
	h	b	b1	b2	D	
40	40	24	24	42	42	140
50	45	26	26	46	51	160
63	50	26	26	45	63	190
80	65	34	34	68	84	400
100	88	48	48	86	114	650

## PROCESS CONNECTIONS Tab.3

Dimensions			Male thread		Type	
06	08	15	G	N	R	A
1/8"	1/4"	1/2"	UNI 228/1	NPT	Radial	Axial
Ø 40	Ø 40 - 63 - 80	Ø 80 - 100	On request			

## NOMENCLATURE

MAV	63	0100-0	08GR	BG	N1	080	25		
•									Pressure gauge type
	•								Tab.1 Diameter Ø mm
		•							Tab.1 Measuring range
			•						Tab.3 Process connections dimensions and type
				•					Tab.2 Measuring element and material
					•				Tab.2 Scale - Dial
						•			Tab.2 Max. working temperature
							•		Tab.2 Accuracy

ACCESSORIES	Flange - Bracket - Taps with pressure gauge holder	Leaflet VISOBAR pressure gauge accessories	Pag.228
-------------	--	--	---------